

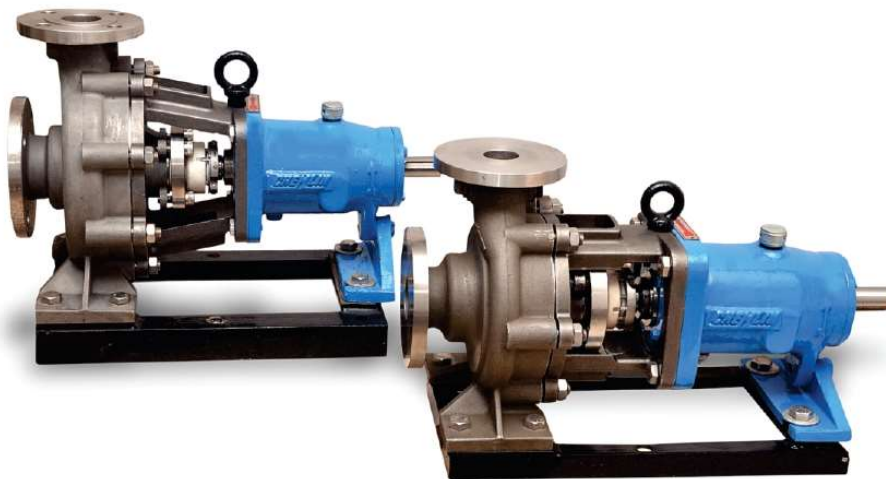

ORIZONTAL CHEMICAL PROCESS PUMPS



CHEMLIN[®]

Designed To Meet Your Specifications!

PERFORMANCE RANGE CHART

Excellent coverage of "CHEMLIN" Make Horizontal Centrifugal Pump Type "AB" gives you better selection at any design point. This means, even at application points falling at the top or bottom of the chart, where the efficiency is traditionally low, you can select a pump to reduce costs. Each pump is designed for optimum performance with reliability in operation at low cost.

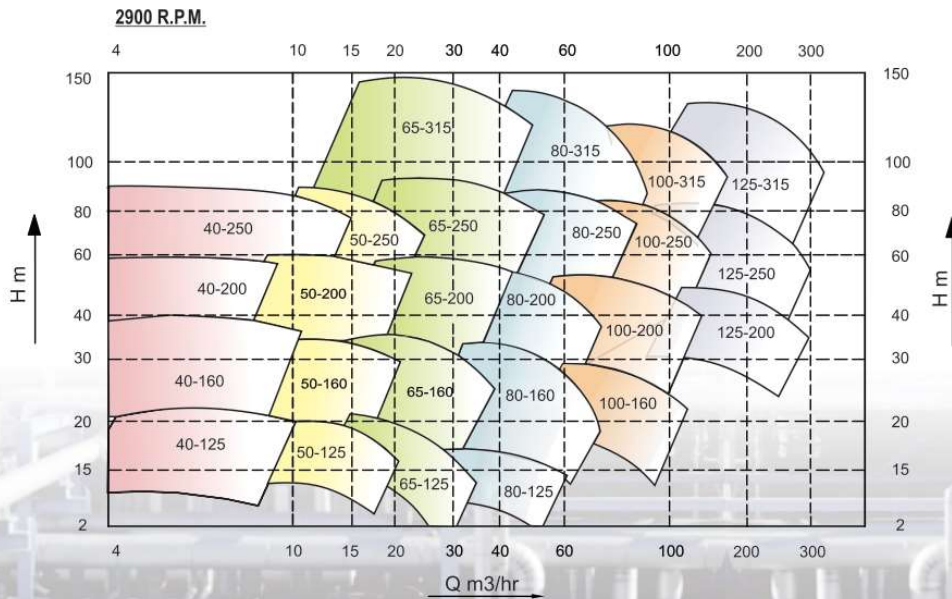
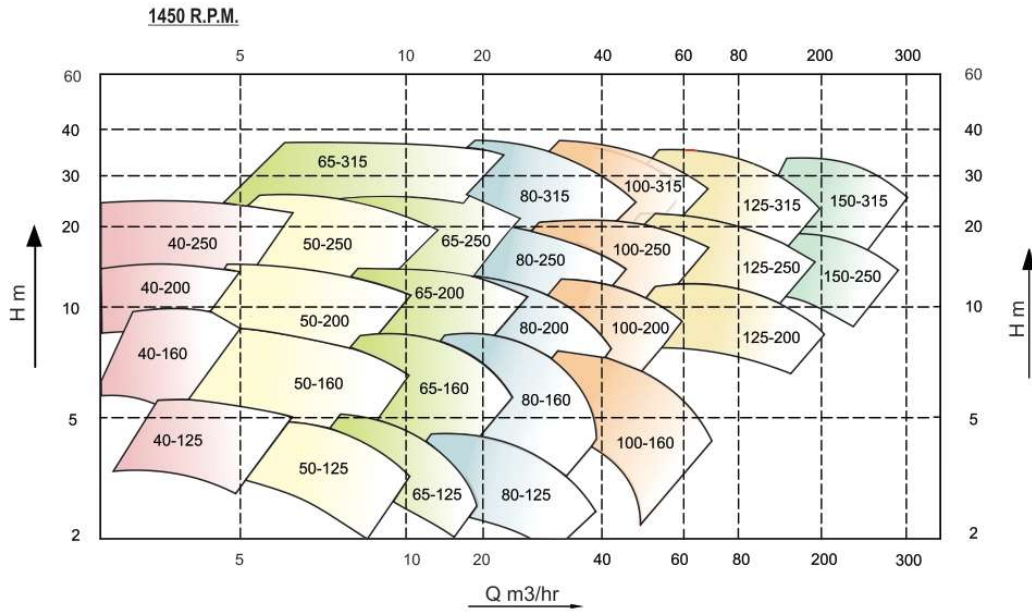

* **Note :** In the designation used for various pump sizes, the first number indicates the Suction Diameter & second number the Maximum Impeller Diameter.

INTERCHANGEABILITY/ STANDARD MODELS

All Pumps with same Bearing Assembly have same Shaft, Impeller nut, Ball Bearings etc. The Shaft seal assembly and Adaptor are same for several pump sizes, hence inventory management is easier and cost effective.

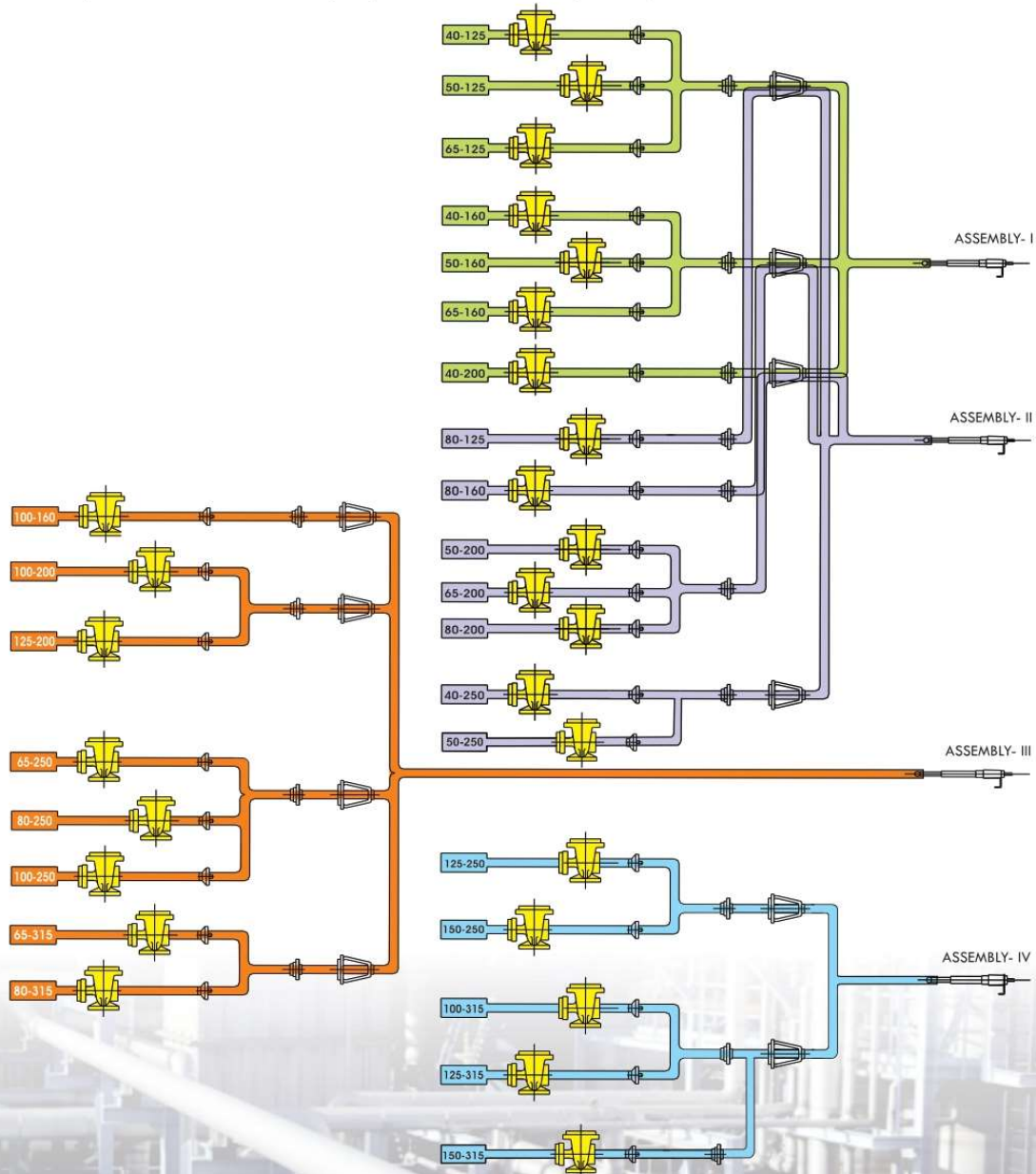

CHEMLIN Horizontal Process Pump Type 'AB' have 27 standard models with well-designed interchangeability of parts. With 4 bearing assemblies, 10 Adaptors & 14 Stuffing Boxes, it allows low inventory with maximum interchangeability.

NOMINAL DUTY POINT & DIMENSIONS

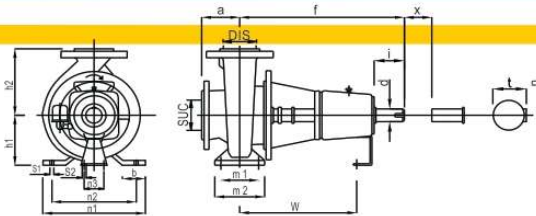

PUMP SIZE			NOMINAL DUTY				DIMENSIONS IN MILLIMETERS																		
			1450 rpm		2900 rpm		PUMP				SUPPORT						BOLT HOLES				SHAFT END		x		
SUC	DIS	IMPELLER NOMINAL	Q	H	Q	H	a	f	h1	h2	b	m2	m1	n1	n2	n3	w	S1	S2	d	i	t	u		
mm	mm	mm	m ³ /h	m	m ³ /h	m	mm	mm	mm	mm	mm	mm	mm	mm	mm	mm	mm	mm	mm	mm	mm	mm	mm	mm	mm
40	32	125	5	20	8	20	80	385	112	140	50	100	70	190	140										
40	32	160	8	32	12.5	32	80	385	132	160	50	100	70	240	190	110	285	M12	M12	24	50	27.3	8	100	
40	32	200	12.5	50	20	50	100	385	160	180	65	125	95	320	250										
40	32	250	20	80	32	80	100	385	180	225	80	125	95	320	250										
50	40*	125	5	20	8	20	80	385	112	140	50	100	70	190	140										
50	40*	160	8	32	12.5	32	80	385	132	160	50	100	70	240	190	110	285	M12	M12	24	50	27.3	8	100	
50	40*	200	12.5	50	20	50	100	385	160	180	65	125	95	320	250										
50	40*	250	20	80	32	80	100	385	180	225	80	125	95	320	250										
65	50	125	5	20	8	20	100	385	112	140	50	100	70	190	140										
65	50	160	8	32	12.5	32	80	385	132	160	50	100	70	240	190	110	285	M12	M12	24	50	27.3	8	100	
65	50*	200	12.5	50	20	50	100	385	160	180	65	125	95	320	250										
65	50*	250	20	80	32	80	100	385	180	225	80	125	95	320	250										
65	50*	315	32	125	125	125	125	500	200	250	80	125	95	345	280										
80	65	125	5	20	8	20	100	385	112	140	50	100	70	190	140										
80	65	160	8	32	12.5	32	100	385	132	160	50	100	70	240	190	110	285	M12	M12	24	50	27.3	8	100	
80	65*	200	12.5	50	20	50	100	385	160	180	65	125	95	320	250										
80	65*	250	20	80	32	80	100	385	180	225	80	125	95	320	250										
80	65*	315	32	125	125	125	125	500	225	280	80	125	95	345	280										
100	80	160	8	32	12.5	32	100	385	160	200	65	125	95	280	212										100
100	80*	200	12.5	50	20	50	100	385	180	225	80	125	95	320	250										
100	80*	250	20	80	32	80	100	385	200	250	80	160	120	360	280										
100	80*	315	32	125	125	125	125	530	225	280	80	160	120	400	315										140
125	100	200	12.5	50	20	50	125	500	200	280	80	160	120	360	280										
125	100	250	20	80	32	80	125	500	225	280	80	160	120	400	315										
125	100	315	32	125	140	140	125	530	250	315	80	160	120	400	315										
150	125	250	20	-	-	-	-	-	250	-	80	160	120	400	315										
150	125	315	32	-	-	-	-	-	280	-	100	200	150	500	400										

These are supplementary to ISO 2858 std. * Discharge size provided one size higher to reduce flow velocities and there by frictional losses in the piping. With this exception, discharge nozzle is one size smaller than suction nozzle.

BASE PLATE DIMENSIONS

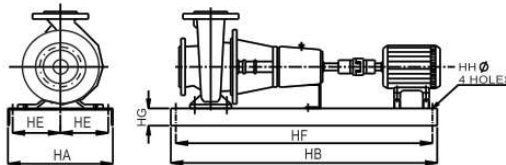

RECOMMENDED FOUNDATION

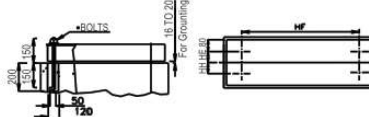

BASE PLATE DIMENSIONS

BASE PLATE NO.	MOTOR FRAME	HA	HB	HE	HF	HH	HG
		MM	MM	MM	MM	MM	MM
01	80M	260	900	115	826	18	75
	90S						
	90L						
	100L						
02	112M	300	1000	130	926	18	75
	132S	300	1000	130	926	18	100
03	132M	300	1120	130	1046	18	100
04	160M	360	1120	160	1046	18	100
05	160M	360	1400	160	1326	18	100
	180M						
06	180L	360	1400	160	1326	23	
	160M						
07	180L	400	1400	180	1326	23	150
	225M						
08	180L	500	1400	230	1326	23	150
09	250M	500	1600	230	1526	23	150
10	315M	400	1800	180	1726	23	150
11	250M	560	1800	260	1726	23	150
12	280S	560	1800	260	1756	23	150

FLANGE DIMENSIONS

NOMINAL BORE	STANDARD			OPTIONAL		
	ND 16-DIN	2533/2543	NO. OF HOLES	ASA 125 /150 LBS	NO. OF HOLES	
PCD	HOLE SIZE		PC	HOLE SIZE		
32	100		4	88.9	14.3	
40	110			98.4		
50	125			120.4		
65	145	18		139.7	17.5	4
80	160			152.4		
100	180			190.5		
125	210		8	215.9		
150	240	23		241.3	22	8
200	295	23	12	298.4		

*NOTE : Dimensions given in catalogue are only indicative & should not be used for construction of foundation unless certified.



Chemlin Pumps are manufactured at a modern manufacturing set-up at Kagal since 1987. This plant has a state-of-the-art technology and instrumentation for pump testing which is done by using a computerized pump testing facility. 'Chemlin' has a strong, experienced and dedicated workforce led by technocrats with years of experience of handling various grades of materials and modern machining practices for achieving excellent Quality of Product. The complete design and manufacturing process is standardized under ISO 9001-2015 Quality Management System. The Business Associates of 'Chemlin' are placed at strategic locations in various parts of the country to give prompt services to all our valued customers. Chemlin Pumps and Valves are being used in various Process Industries all over India & abroad. The products are designed and manufactured to International Standards and offer all desired features and options for maintenance free operations. 'Chemlin' brand products are serving the Chemical and Process Industry for over last three decades and are the first choice of Maintenance Engineers.

Chemlin Pumps are built using quality materials, with precision workmanship and thorough testing. The parts which are subject to abrasion are heat treated. The units are built with standard dimensions and accuracy is maintained. The pumps are manufactured to DIN, ISO, ANSI Standards. Many of the important features of the pump generally comply to API 610 6th Edition.

APPLICATIONS :

- In pumping corrosive & abrasive liquids
- Organic & In - organic liquids in Chemical Industries
- Fertilizer & Petrochemical Industry
- Paper and other Process Industries.
- Sugar Industry
- Pharmaceutical Industry

RANGE :

Capacity : Upto 300 M³/HR
Temperature : 20°C to 150°C
Head : upto 140 MLC
Size : 32mm to 150 mm
Working Pressure : 18 Kg/cm²

DESIGN FEATURES :

1. Horizontal, top center-line discharge, end suction, with back pull-out construction, semi-open and closed impeller designs.
2. Low NPSH values.
3. The Stuffing Box is designed for using Mechanical Seal or Gland packed Sealing arrangement, low downtime in maintenance.
4. Impeller designs with thrust balancing vanes / holes.
5. Maximum interchangeability of parts hence low inventory of spares.
6. Rigid construction, longer life.
7. Standard coupling with spacer elements, low down-time and easy maintenance.

MATERIAL OF CONSTRUCTION :

Cast Iron, Cast Steel, Stainless Steel of different grades, Non-Ferrous materials, DIN 4136, CA 15, CA6NM, CN7M, R-55, CD4MCu, Hastalloy grades and Special Alloy Steels.

- In search of excellence, we reserve the right to alter or change specifications without prior notice.

FOR MORE INFORMATION CONTACT OUR NEAREST BUSINESS ASSOCIATES OR WRITE DIRECTLY TO US

- PUNE : pune@chemlinindia.com
- HYDERABAD : hyderabad@chemlinindia.com
- N. DELHI : delhi@chemlinindia.com
- ERNAKULAM : ernakulam@chemlinindia.com
- BARODA : vadodara@chemlinindia.com
- KOLKATA : kolkata@chemlinindia.com



Chemlin Pumps & Valves Pvt. Ltd.

- Office : F-5, 'Atharva Estate', 238/2, E, Tarabai Park, Kolhapur-416 003
- H.O. : 0231-2653123 / 2652098
- Fax : 0231- 2655389 . E-mail : sales@chemlinindia.com
- Works : 235/6, Pune- Bangalore Road, Kagal - 416 216. Dist. Kolhapur (Maharashtra) INDIA
- Phone : 02325 - 244108. E- mail : works@chemlinindia.com
- Website : www.chemlinindia.com

Represented By